

ANNUAL REPORT 2018-2019

SUNSHINE COAST
Environment Council
www.scec.org.au



ABOUT SCEC

SCEC is the peak environmental advocacy group on the Sunshine Coast. Established in 1980, SCEC represents more than 50 community groups working on a range of environmental issues as well as over 6,000 individual supporters.



MISSION & VISION

Our Vision

An ecologically sustainable world achieved through individual and community stewardship of the natural environment at local, regional and global level.

Our Mission

Through leadership, education and environmental activism, to encourage Sunshine Coast individuals and communities to support and participate in working towards the goal of environmental sustainability.

CONTENTS

PRESIDENT'S REPORT 3

ADVOCACY 4-9

EVENTS 10

ORGANISATION UPDATE 11

PEOPLE & GOVERNANCE 12

FINANCIAL REPORT 13

MEMBER GROUPS 14

SPONSORSHIP & GRANTS 15

President's Report



Vivien Griffin
President

I have had the privilege of being President of SCEC for the last 3 years and am now stepping down to allow for new energy and passion to take the leadership reins. There is no doubt in my mind that the environment is facing an existential threat from climate change. So the challenge for SCEC and its member groups is how to "think global, act local". As the outgoing President, my request to SCEC, its member groups and friends is to grapple with every iota of ingenuity that you possess to consider how you take the climate action message to your community in creative and engaging ways.

SCEC has a proud history of fighting for the protection of important ecosystems throughout the region. However, the world has become so much more complicated. It was (relatively) easy to engage with a community to protect local bushland. Now, how do you engage with the more abstract issues of carbon emissions from electricity, transport and waste? How do we live up to the hopes of those students who were brave enough to go on strike for the climate? How do we cut through the white noise of the interminable news and cooking shows? How do we stop talking amongst ourselves and really engage with the broader community? I am sure SCEC and its member groups are up to the challenge and I look forward to an exciting year ahead for all.

We have had a bumpy ride in terms of having a permanent Coordinator, but we now have the wonderfully capable Natalie Frost (when she returns from parental leave). Despite being heavily pregnant, Natalia took on the reins of World Environment Day which gave her a unique introduction to Queensland's heavy downpours. In the meantime we have been fortunate to draw upon the skills of Peter Hogg as acting Coordinator, whose steady hand has kept the good ship SCEC moving forward. Narelle McCarthy, our Liaison and Advocacy officer, has taken on the demands of the Sekisui court case in addition to her normal huge workload, for which I thank her. The SCEC committee of Jillian Rossiter, Sue Etheridge, Jacki Boyce, Peter Hunnam, John Salter and Mick Tyrell have all been a great sounding board and support to Natalie, Narelle and Peter over the year. Some members are staying on and will provide valuable continuity for new Board members.

SCEC has always been fortunate in attracting generous and capable volunteers, and whether you contribute for months or years, rest assured that your contribution is highly valued.

A handwritten signature in blue ink that reads "V. Griffin". The signature is written in a cursive style on a light-colored, slightly textured background.

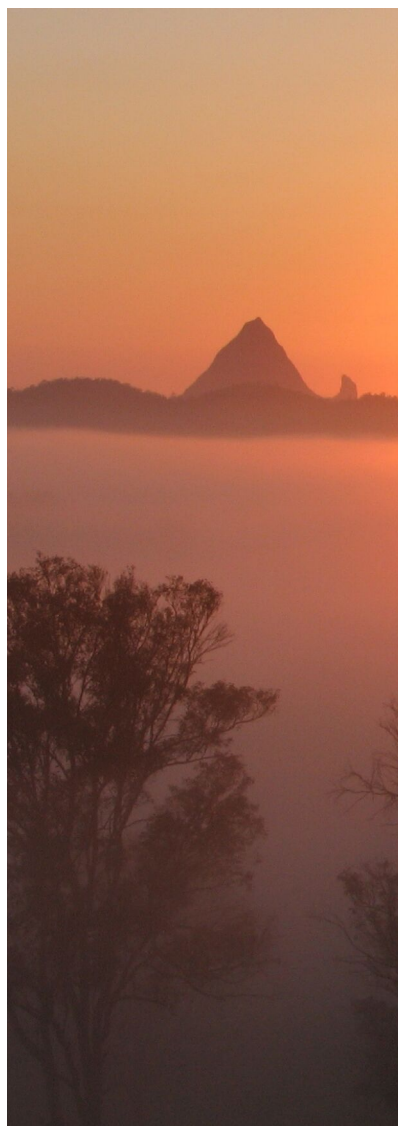

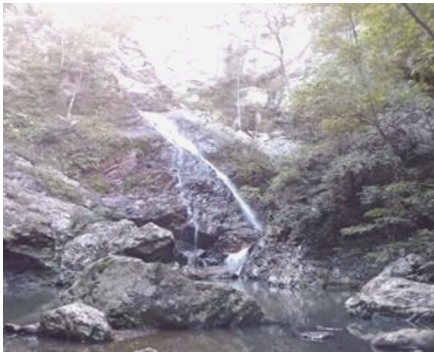

SCEC is prominent in the media advocating on behalf of the environment.
SCEC attends numerous meetings as environmental and member advocates.
SCEC continues to put our environment first with submissions on environmental & planning issues.
SCEC is represented on boards, reference groups & alliances across South East Queensland.

Advocacy

SCEC was as dynamic as ever across a range of issues and projects this year - just as we have been since 1980! Whether it was challenging the planning pandemonium which has descended upon the coast, helping turn the tide on plastic pollution or pushing for action on climate change, better environment laws and an expanded National Park estate, SCEC's role as the peak environmental advocacy group for the region continues to come to the fore.

DEVELOPMENT DILEMMAS – DESPAIR, DISGUST AND DETERMINATION

Unfortunately, this was a year of 'inappropriate developments' and multiple, major planning scheme amendments requiring a concerted effort in terms of advocacy and comprehensive submissions. Despite being described as a document (and a statutory one at that!) which would provide "certainty for all" when it was adopted in May 2014, the description has conveniently switched to it being "a living document." This is apparently meant to justify the rapid and significant amendments to which it has been subjected, particularly in recent times.

STILL THE WRONG WAY SEKISUI!



The Sekisui saga carried over from our previous reporting year making it a focus of our work yet again. Having successfully challenged the proposed planning scheme amendment a couple of years ago, 21 June 2018 saw the Sunshine Coast Council narrowly approve the controversial proposal for a high-rise, high-density residential, retail and hotel development at Yaroomba - a significant turtle nesting site for endangered loggerheads and one of the Sunshine Coast's last untouched coastal jewels. This decision was made despite Sekisui's development application having significant conflicts with the planning scheme and almost 10,000 submissions objecting to the proposal.



A passionate community takes action

But the fight to save Yaroomba wasn't over! With the support of the wider community and the fabulous Friends of Yaroomba right behind us, SCEC and community group Development Watch Inc, lodged a Planning & Environment Court Appeal in November appealing the Sunshine Coast Council's appalling decision. So, in taking on Council and Sekisui House, our commitment to saving Yaroomba and the broader Sunshine Coast region from inappropriate development continues.

BADDERAM FOR BUDERIM- REALLY?

The controversial Buderim development marketed as 'Badderam' was approved by Councillors 9-2 despite a raft of planning issues and environmental considerations. Such was the extent of conflict with the planning scheme (the former Maroochy Plan 2000) against which it was assessed, that some 480 specific conditions were applied plus an essential Infrastructure Agreement (IA).

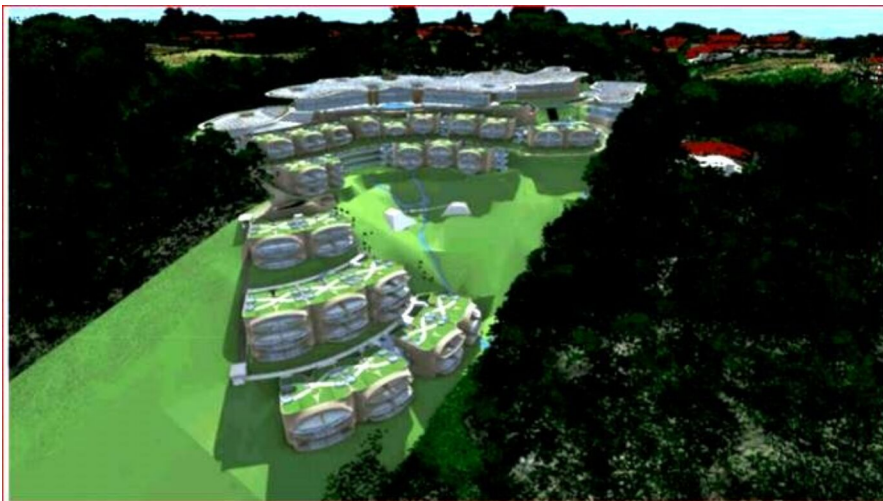

The purported 'benefits' all hinged on the delivery and operation of a 5 star hotel being a key part of the IA and a heavy reliance on over-stated economic assumptions which were exposed by the economic peer review. These economic assumptions and social benefit claims clearly stretched the 'public interest' test and convinced Councillors to somehow justify such a massive departure from sound planning provisions and other relevant considerations.

So, despite the many question marks and acknowledging a substantial amount of fundamental, detailed work was required, the concept was unfortunately 'sold' to the majority of Councillors. The artist's impressions and the idea might appear attractive, but the reality and complexity of this proposal shows it severely compromises sound planning provisions and is at odds with the character and intent for this locality.

This decision again showed a worrying trend of virtually ignoring town and locality plans in favour of flawed economic 'arguments' financial investment and viability uncertainties and exaggerated community benefits.

CONSERVATION NOT MORE DEVELOPMENT FOR PALMVIEW... ALMOST

However, Council did get it right with their vote on the Palmview Urban Investigation Areas!

There was cause for some celebration as Sunshine Coast Council supported the recommendations of Council Officers to have land adjacent to the (questionable!) Harmony development at Palmview retained for conservation and flood storage. The draft determination for the approximately 200ha comprising three parcels sit outside the declared Palmview Structure Plan Area and are referred to as the Palmview Urban Investigation Areas. The parcels of land in question, which have significant ecological and habitat values, function as wildlife corridors and are almost entirely flood prone. They also form important linkages with the nearby Mooloolah River National Park and Lower Mooloolah Environmental Reserve.

The controversial renegotiation of the Palmview Structure Plan between the Sunshine Coast Council and the developers, which delivered concessions on top of existing, generous development approvals, meant these parcels of land were once again in developers' sights.

However, the landowners were unable to make a case for development of these parcels for urban purposes, nor override natural hazards and risks for proposed uses which are already catered for in the approved Palmview Structure Plan. The draft Determination was subjected to further submissions from the landowners as part of the review process to form the Final Determination.

FARM OR FACTORY?

The factory farm facility on the Maroochy River, a code assessable was lodged with Sunshine Coast Council by an interstate company to build an industrial scale high tech intensive horticulture business on rural land directly in front of Mt Ninderry in the Maroochy River valley. It is slated for the southern floodplains of the upper estuary of the Maroochy River. Currently there is no industry or development of this nature in this area, only pastures, orchards, recreational areas, cane fields, residential acreages and horse properties. The introduction of 'intensive horticulture', with significant monolithic greenhouse structures, large industrial scale sheds, woodchip boilers for CO2 production and continual operations, will be the first of its kind within the area. If this facility was to be allowed, it would significantly change the character, lifestyle and environmental attributes of the Maroochy River Valley, while irreparably damaging the 'significant views' of the area. The Maroochy River Valley residents banded together for a strong and justified challenge to this proposal.



Image: View from Mt Ninderry where the 185,000m²+ facility is to be located in the centre (Oct 2018)

MAJOR PROJECTS

Major infrastructure projects could be seen literally coming out of the ground this year. While we see and comment on documentation, two-dimensional maps and schematics and ‘environmental management plans’ for numerous projects, the physical impact on the natural environment when the dozers go in clearing vegetation, which irreversibly alters landscapes and habitats remains confronting. It is also compelling for pursuing better protections for nature. SCEC therefore remains necessarily engaged on environmental matters relating to the Sunshine Coast Airport Expansion Project, the construction of the Caloundra Road to Sunshine Motorway upgrade and other projects.

SEQ KOALAS IN CRISIS

The Queensland Koala Expert Panel delivered its final report in late 2017 recommending urgent action to reverse population declines in South-East Queensland and secure the long-term survival of the species.

With progress on the implementation of these important recommendations frustratingly slow and lacking firm commitment from government, particularly to close planning and development loopholes and exemptions, SCEC joined an alliance of conservation groups, including EDO, QCC and TWS to call for an immediate moratorium on development and tree clearing in koala habitats across Queensland.

HELPING TURN THE TIDE ON PLASTIC POLLUTION

Through continued advocacy and involvement with Boomerang Alliance, other groups and the government, we saw some significant breakthroughs in tackling our appalling volumes of waste with the banning of single-use plastic bags and the introduction of a Container Deposit Scheme in Queensland. Legislation was also drafted to progress the implementation of a long overdue waste levy.

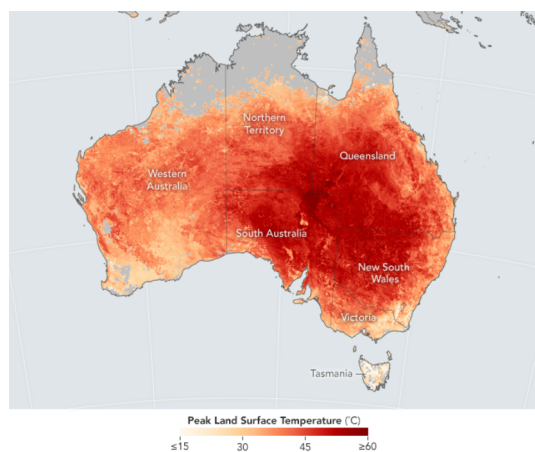

TURNING UP THE HEAT FOR CLIMATE ACTION

SCEC hosted an event and coordinated media for The Australia Institute’s Sunshine Coast HeatWatch report, HeatWatch: Projections of increasing extreme heat on the Sunshine Coast in late October. The HeatWatch project highlights the current increases in extreme heat as a result of global warming for specific locations around Australia using BoM data and CSIRO climate projections.

The project presented compelling material to assist local climate campaigners to highlight the direct impacts of global warming on local communities to help build support for climate action. The Sunshine Coast is certainly facing, and already experiencing these challenges and SCEC is stepping up its climate change actions and initiatives.

LEGISLATIVE REFORM ON THE AGENDA

SCEC made submissions and provided feedback on various pieces of draft legislation such as the Vegetation Management and Other Legislation Amendment Bill (VMOLA) 2018 and Local government reform starting with the welcome Local Government Electoral (Implementing Stage 1 of Belcarra) and Other Legislation Amendment Bill 2018, climate policy and the need for stronger environment laws... amongst many others. The need for planning reform is also ongoing as we continue to work with groups across South East Queensland as part of the SEQ Alliance.

VALE JOHN SINCLAIR AO



The passing of John Sinclair AO in January this year not only signified the loss of a conservation giant and a fierce environmental advocate, but that of a person who was at the vanguard of the conservation movement. John's unshakeable determination to protect his beloved K'gari (Fraser Island) shone as a beacon of strength and knowledge and epitomised what it means to fight, and ultimately win, for nature. We and the environment are forever the beneficiaries of this incredible human being. John's legacy and inspiration will never be forgotten.

SCEC MEMBER GROUPS CONTINUE TO INSPIRE

SCEC continues to be humbled and privileged to represent such a broad depth of experience, passion and dedication. Our wonderful member groups continue their amazing and tireless work for the environment, conservation and sustainability of the Sunshine Coast, Noosa and Moreton Bay regions. We are proud to represent this impressive membership of organisations and individuals. You add weight and strength to our advocacy work. Thank you for your awesome efforts!



The future looks bright with these eco-warriors! Image: Coolum and North Shore Coast Care.

This year's Sunshine Coast Council Australia Day Awards showed the breadth of community achievement and spirit in our region. SCEC was immensely proud to have two of its' member groups as joint winners of the Environment & Sustainability category, the inspiring junior eco-leaders of Coolum & North Shore Coast Care and the dedicated and tireless Wildlife Volunteers Association-affectionately known as the WILVOs represented by Sylvia Whiting.

SCEC rounded out the Awards honour roll with the incredible Susie Chapman, a past SCEC Coordinator & volunteer and currently Senior Scientist & Regional Agricultural Landcare Facilitator for Healthy Land and Water, being awarded a well-deserved Medal of the Order of Australia (OAM) for her passion and dedicated service to conservation and the environment over a long period of time on the Sunshine Coast. Congratulations and heartfelt thanks to everyone for the valuable and often 'unsung' contributions to our environment and community each and every day!

Sincere thanks also to my incredible colleagues Jacki Boyce, Natalie Frost and Peter Hogg throughout the year, the wonderful volunteers and the Management Committee for their support.

BUT WAIT... THERE'S MORE!

There is much more to SCEC's advocacy and engagement work that can be shared here, so please check out our website and keep up date via our social media platforms and monthly eBulletins (and please share these with your members too!)

With gratitude & continued passion,

A handwritten signature in black ink that reads "Marella". The signature is written in a cursive, flowing style.



SCEC organised and participated in events and engagements across the Sunshine Coast region.

Representatives from over **55** community organisations participated in SCEC events which were attended by **8000+** people.

Events

Throughout the year SCEC both hosted its own events and assisted and participated in other community engagement and fundraising events, partnering with our Member Groups. World Environment Day once again dominated our events calendar. WED has become a staple on the Sunshine Coast events calendar, and the 2018 edition attracted over 8,000 people to Cotton Tree to see the best that the Sunshine Coast and its environmental groups had to offer. Now the biggest single day environmental festival in Queensland, WED 2018 featured a Renewables Expo, a Farm Expo, and over 90 stalls including 42 community groups. WED continues to be a major opportunity for our Member Groups to showcase their organisation and their activities and to foster greater public engagement.



Now in its third year, Drag Queen Bingo, was again held at the Coolum Civic Centre in November. Bigger and better than ever, this irreverent event raises much needed funds for SCEC's activities. Always a sell-out, our diverse Drag Queen Bingo audience are assured a fun-filled night. Friends of Yaroomba provided our guests with wonderful Mexican Food raising funds for the Save Yaroomba campaign.

SCEC was involved in many other events during the year, engaging with our Member Groups, policy makers, and the wider community. SCEC organised our member group roundtable, participated at the Ministerial Environment Roundtable, and the Maleny Wood Expo and proudly partnered with our Member Groups to deliver events including a popular electric bike riding program, Sunshine Coast Climate Action Now's "Love Song To The Earth" concert and our continued support of Save Yaroomba events.



Combined with our social media reach, SCEC events and engagements with our member groups and the community make us a potent voice for the environment on the Sunshine Coast.



SCEC worked with over **60** volunteers.
Average readership of over **1000** for
electronic communications.
Over **125,000** people reached through social
media and over **4,400** Facebook followers.

Organisation Update

This year again saw changes at SCEC. Our Coordinator Jacki Boyce left SCEC to take up a position with the Nature Conservation Council as their Senior Digital Campaigner. Jacki made a wonderful contribution to SCEC during her time with us, bringing wonderful energy, experience and skills to the role. During her tenure as Coordinator, Jacki brought a focus to the question of SCEC's sustainability and began the important work of developing a fundraising strategy for SCEC. Among her many achievements, she also delivered an outstanding World Environment Day Festival. All of us at SCEC knew that filling her shoes would be a big task.

After a stringent recruitment process that saw a number of high quality applications, Natalie Frost joined SCEC as our Coordinator in November 2018, returning to Australia from the UK to do so. Natalie has brought wonderful energy, professionalism and experience to the Coordinator role and SCEC is extremely lucky to have someone of her calibre and drive on our team. In her short time with us, she has already made strong and positive contributions to SCEC.

Many of SCEC's administrative functions are performed by the volunteers who give generously of their time to assist us in the work that we do. Whether it is manning reception, general office duties, finance, research, preparing documents or assisting with social media and marketing, we are extremely lucky to have the services of volunteers dedicated to making a real difference to the Sunshine Coast's environment.

This year we also were lucky to have two interns from the University of the Sunshine Coast do their placement with us. Their assistance with our website, social media and marketing was invaluable.





People & Governance

GOVERNANCE

SCEC is led by a volunteer Management Committee who oversee the direction of the organisation and govern according to the principles of good governance for not-for-profit organisations. Our Management Committee helps determine and is guided by the SCEC strategic and operational plans and by monthly staff and financial reports. We would like to express our thanks to our retiring Management Committee members Vivien Griffin, John Salter, Jacki Boyce and Michael Tyrell for their efforts on behalf of SCEC. We would particularly like to acknowledge the contribution of Vivien Griffin who has served as SCEC President for the last three years.

VOLUNTEERS

SCEC could not operate without the ongoing support of its volunteers. Our volunteers assist with general office and reception duties, maintenance, finance, marketing and social media, help organise and participate in SCEC events and many other tasks. SCEC would like to particularly acknowledge the following volunteers for their outstanding contribution:

- Jane Minor
- Debra Hoyer

MANAGEMENT COMMITTEE

President Vivien Griffin
Vice –President Jillian Rossiter
Treasurer Sue Etheridge

Member John Salter
Member Jacki Boyce
Member Peter Hunnam
Member Michael Tyrell

STAFF

Coordinator Natalie Frost
Liaison & Advocacy Narelle McCarthy
WED Festival Coordinator Jacki Boyce



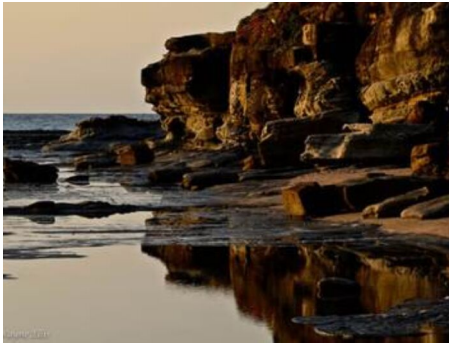

Finance

Balance Sheet - 31 March 2019	
Assets	
Cash on hand	\$21,015
Trade debtors	\$55
Inventories	\$0
Property, plant & equipment	\$9,038
Current tax assets	\$2,381
Total Assets	\$32,489
Liabilities	
Trade creditors	\$5,421
Tax liabilities	\$8,048
Payroll provisions	\$9,109
Other	
Total Liabilities	\$22,578
Net Equity	\$9,911

Financial Performance 2018-2019	
Income	
Membership Fees	9,425
Donations	26,833
ELF Dispersal	54,000
Sponsorships & Grants	108,260
Activity generated	23,650
Other Income	1,859
Adjustment	0
Total Income	224,027
Expenses	
Office	34,721
Motor vehicle	4,168
Employment	156,576
Projects/Events	32,256
WED	33,096
Other Expenses	3,606
Total Expenses	264,423
Profit	-40,396

Total grants received increased by 12%

Investment in projects and events increased by \$25K

\$17K increase in donations

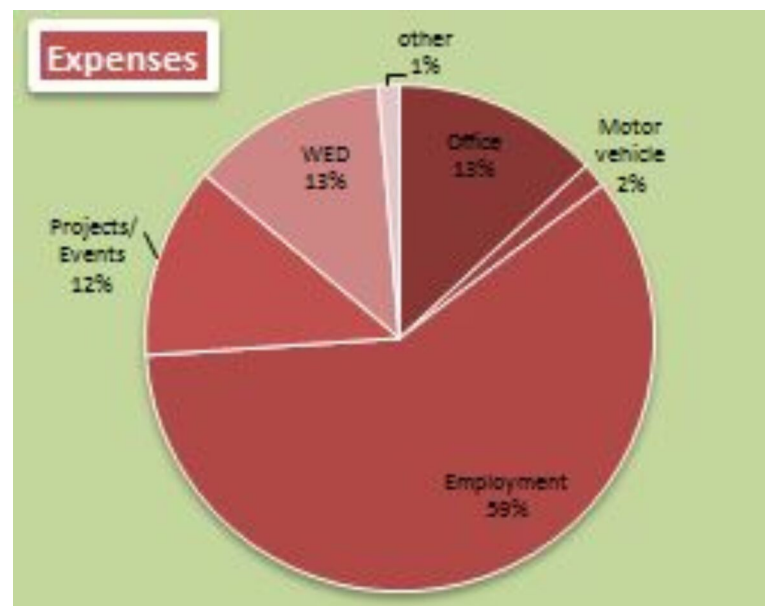
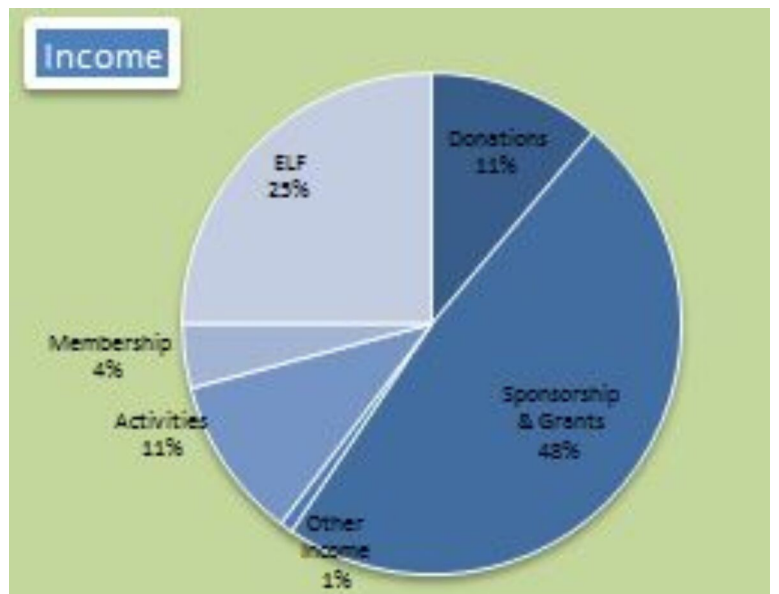

Overall, SCEC has had a positive financial year. Membership Fees, General Donations and Grants all increased, and expenses were well constrained. SCEC results show a loss of \$40396DR for the year, and our reserves have now been reduced to \$9911CR . However, this was due to \$46000 of the ELF dispersal not being received until April 2019.

Looking ahead, our 19/20 results should show a reversal of the 18/19 year, with an adjusted increase in our financial reserves.

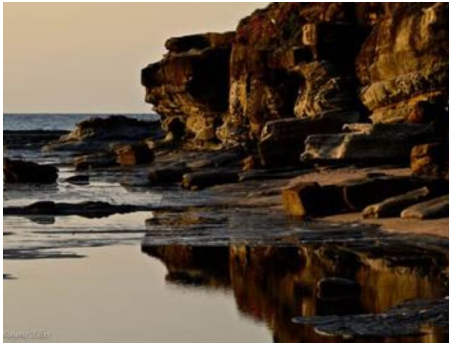

Member Groups

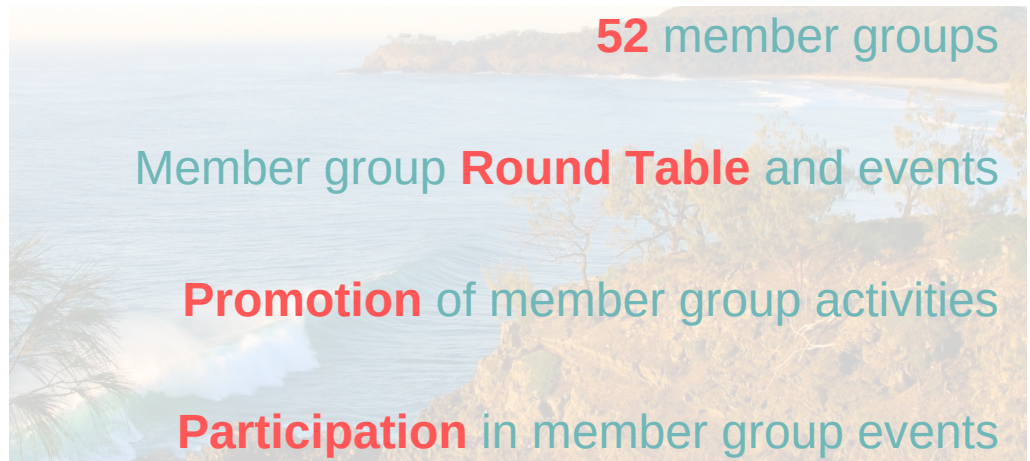

SCEC acknowledges the amazing work of its member groups who all contribute so much to the preservation of the natural environment on the Sunshine Coast. SCEC is privileged to be representing such diverse and committed organisations and our advocacy is strengthened by the breadth and depth of the people involved in them. To all these people and organisations we say: **THANK YOU!**

Australian Marine Conservation Society
Barung Landcare
Bat Rescue Inc
Blackall Range Land Use and Planning Association
Bribie Island Environmental Protection Assoc. Inc - B.I.E.P.A
Bunya Bunya Country Aboriginal Corp
Caloundra Catholic Community Social Justice Network
Conondale Range Conservation
Coolum and North Shore Coast Care
Coolum Residents Association
Coolum Women's Shed
Crystal Waters Community Cooperative Ltd
Currimundi Catchment Care Group
Development Watch Inc
Ecollaboration
Fraser Island Defenders Org
Friends of Lake Weyba Inc
Friends of Yaroomba
Glasshouse Mountains Advancement Network Inc - GMAN
Hinterland Bush Links
Lake Baroon Catchment Care Group Inc
Landsborough Area Community Association
Manduka Cooperative
Maple Street Co-operative Society Limited
Maroochy Wetlands Sanctuary Support Group

Mary River Catchment Coordinating Committee
Mooloolah River Waterwatch & Landcare Inc.
Nambour Transition Towns
Night Eyes Water & Landcare Sunshine Coast
Noosa and District Landcare Group
Noosa Community Biosphere Association
Noosa Integrated Catchment Association
Noosa Parks Association Inc.
OSCAR
Permaculture Noosa Inc
Petrie Creek Catchment Care
Queensland Folk Federation / Woodfordia
Queensland Water and Land Carers
Reef Check Australia
Stop Adani Sunshine Coast
Sunshine Coast Bushwalkers Club
Sunshine Coast Climate Action Now SCCAN
Sunshine Coast Lets Inc
Surfrider Foundation Sunshine Coast
Sustainable Population Australia
Take Action for Pumicestone Passage - TAPP Inc
Ten Little Pieces
The Overview Institute Australia
Wildlife Preservation Society of Queensland - Sunshine Coast & Hinterland Branch (WPSQ)
Wildlife Volunteers Association Incorporated - Wilvos
Yandina and District Community Association
Yandina Community Gardens Inc
Zero Emissions Noosa



Sponsorships & Grants



SCEC gratefully acknowledges the **generous support** of these organisations

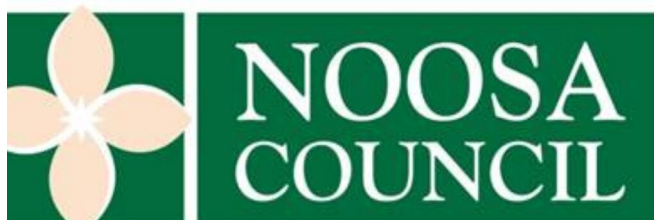

Sunshine Coast Environment Council
3 Porters Lane
PO Box 269
Nambour QLD, 4560
07 5441 5747

info@scec.org.au
www.scec.org.au

www.facebook.com/SunshineCoastEnvironment Council

SUNSHINE COAST
Environment Council
www.scec.org.au

